



IS12T

Basic Manual

[Contents](#)

[Getting Ready](#)

[Basic operation](#)

[Phone](#)

[Setting global function](#)

[Mail](#)

[Internet Explorer](#)

[People](#)

[Messaging](#)

[Camera](#)

[Marketplace](#)

[System settings](#)

[Application settings](#)

[Resetting your phone](#)

[Appendix/Index](#)

Preface

Thank you for purchasing IS12T.

Before using your IS12T, be sure to read IS12T Basic Manual (this PDF manual) to ensure correct usage. After you have finished reading this manual, store this PDF manual and the printed manuals in safe places so you can retrieve them whenever you need them.



memo

Basic Manual (this PDF manual) describes basic operations of major functions of IS12T.

For detailed descriptions on various functions, refer to IS12T full Instruction Manual (Japanese), which is available on the au homepage.

Downloading Manuals

You can download the Basic Manual (this PDF manual) and the full Instruction Manual (Japanese) from the au homepage.

From a PC: <http://www.au.kddi.com/torisetu/index.html>

Online Manual

Online manuals are also provided on the au homepage, which contents are from the full Instruction Manual (Japanese) and are reorganized in a searchable format.

From a PC: <http://www.au.kddi.com/torisetu/index.html>

Safety Precautions

Be sure to read the Safety Precautions "安全上のご注意" in the full Instruction Manual (Japanese) to ensure proper usage of IS12T.

For troubleshooting, check the symptom of your IS12T in au お客様サポート (au Customer Support) on the au homepage.

- From a PC: <http://www.kddi.com/customer/service/au/trouble/kosho/index.html>

Before Using IS12T

- You cannot receive or make calls in a location where the signal cannot be received, even within the service area. Calling may not be available in a location where the signal is weak. If you move to a location where the signal is weak during a call, the call may be interrupted.
- IS12T is a digital cell phone and can maintain a high call quality until the signal weakness reaches its limit. Therefore, once the limit has been reached, the call may be disconnected suddenly.
- Note that IS12T uses signals which may be intercepted by a third party. (However, the CDMA/GSM system enables highly confidential call communications.)
- IS12T is a wireless station which is compliant with the Radio Act, and may be subject to inspections regulated by the Radio Act.
- When you insert the au IC-Card, the product number information of your IS12T is sent to the au server for the security and operation status notification of IS12T.
- Always be considerate of others around you when using your IS12T in public places.
- For a child's use, read IS12T Basic Manual and give your child instructions on proper use.
- IS12T is a cell phone compatible with the international roaming service. Each network service which is described in the Basic Manual varies depending on the area or service. For details, refer to the supplied Global Passport Owner's Guide (Japanese).

Cell Phone Etiquette

Cell phones always emit weak radio waves when power is on. Use cell phones in an enjoyable and safe manner without forgetting to be considerate of others around you.

■ Use of cell phones is not allowed in some places.

- Using a cell phone while driving is dangerous and prohibited by law.
- Using cell phones on aircraft is prohibited by law except for the following cases.
 - For departure: From when you get on board until all boarding gates are closed
 - For arrival: From when any of the gates opens until you get off the aircraft

■ Be considerate of where you use the cell phone and how loudly you talk.

- Do not make calls in theaters, museums, libraries, and other similar places. Turn power off or turn on mode so as not to disturb others around you by ring tones.
- Do not use the cell phone on a street where you might interrupt the flow of pedestrians.
- Move to areas where you will not inconvenience others on trains or in hotel lobbies.
- Refrain from talking in a loud voice.
- Obtain the permission of other people before you take their photos with the cell phone's camera.

■ Be considerate of people around you.

- Some people close to you in crowded places such as packed trains may be using a cardiac pacemaker. Turn the cell phone off in such places.
- Abide by the rules of hospitals and other medical institutions where it is forbidden to use or carry cell phones.

Basic package and main peripheral equipment

■ IS12T

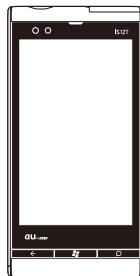

■ Accessories

- Battery pack



■ Sample

- microUSB-USB conversion cable

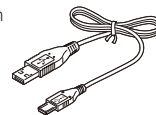

- Start Here Guide (Japanese)
- IS12T Setup Guide (Japanese)
- Global Passport Owner's Guide (Japanese)
- au International Call Guide (Japanese)
- warranty (Japanese)
- User's Manual (Japanese)

The following items are not included in the package.

- AC adapter
- earphone

• Please purchase the specified charger (sold separately).

Illustrations and descriptions in this manual

Note on key illustrations

In this manual, the key illustrations are simplified as shown below.

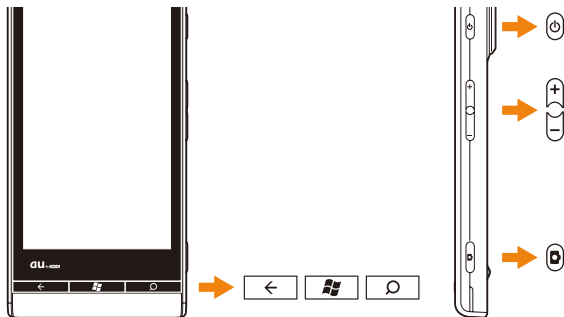

Note on screenshots

The screenshots in this manual are simplified and may look different from the actual screens.

Security code and PIN code

Security code and password

IS12T has various security codes that you can use. The available security codes are as follows. Do not forget the security codes that are set as they are necessary for various operations and contracts.

● Security code

Usage	① To do remote operation of voice mail and call forwarding services from a landline phone
	② To use Customer Service Center and to do various inquiries, applications, and modifications on the au homepage
Default value	A four-digit number chosen by the customer and noted on the application form

● PIN code

Usage	To prevent unauthorized use of an au IC card by third parties
Default value	1234

Functions to protect your privacy

IS12T has the following functions to protect privacy of the stored data.

Function	Setting
Setting password to unlock the screen	For instructions, see "Restricting others from using".

PIN code

You can set IS12T to require PIN code entry every time the power is turned on, to prevent unauthorized use of the au IC card by a third party. If the PIN code is incorrectly entered three times consecutively, the PIN code will be locked. Use the PUK code to unlock the PIN code.

■ Setting PIN code

At the time of purchase, the PIN code is not to be required to use phone. You can turn on "SIM security" by following the procedure below. After turning on "SIM security", you will be prompted to enter the PIN code every time you start your phone. The PIN code is also required when you turn on "SIM security".

1  →  →  → **Flick to display "applications" → "phone"**

2 **Set "SIM security" to On**

You are prompted to enter the PIN code.

3 **Enter the PIN code → "enter"**

■ PUK code

Enter the PUK code when the PIN code is locked.

- PUK code is an eight-digit number given at the time of purchase, and is printed on the back side of the plastic card where your au IC card is attached.
- When you enter the PUK code, set the new PIN code.
- If the PUK code is incorrectly entered ten times consecutively, contact an au shop, PiPit or the Customer Service Center.



memo

- ◎ When the PIN code is locked, IS12T may be restarted for the security reasons.

Waterproof/Dustproof function

IS12T provides waterproofness of IPX5 equivalent^{*1} and IPX8 equivalent^{*2} and dustproofness of IP5X equivalent^{*3} by firmly closing the back cover and external connection jack cap (by company testing method).

- *1 IPX5 (former JIS protection code 5) equivalent
A phone keeps functioning after applying a jet flow of 12.5 L/min. from every direction from a distance of approximately 3 m for at least 3 minutes using water nozzle in 6.3 mm inner diameter.
- *2 IPX8 (former JIS protection code 8) equivalent
A phone keeps functioning after being slowly submerged to depth of 1.5 m in static tap water at room temperature, left there for approximately 30 minutes and then taken out, and the mobile phone keeps shooting still pictures or videos in approximately 30 minutes in static tap water at room temperature.
- *3 IP5X (JIS protection code 5) equivalent
A phone is protected to keep functioning and safety if the dust for testing dustproofness (in diameter 75 μm or less) is entered to the phone.

Contents

Preface.....	ii
Safety Precautions.....	ii
Before Using IS12T.....	ii
Cell Phone Etiquette.....	1
Basic package and main peripheral equipment.....	1
Illustrations and descriptions in this manual.....	2
Note on key illustrations.....	2
Note on screenshots.....	2
Security code and PIN code.....	2
Security code and password.....	2
Functions to protect your privacy.....	2
PIN code.....	3
Waterproof/Dustproof function.....	3

Contents.....	4
----------------------	----------

Getting Ready.....	6
---------------------------	----------

Names of parts and their functions.....	6
Closing external connection jack cap.....	7
Removing/Attaching the battery pack.....	8
Removing a battery pack.....	8
Attaching battery pack.....	9
Charging.....	10
Charging using AC adapter (sold separately).....	10
Turning power on/off.....	11
Turning power on.....	11
Turning power off.....	12
Sleep mode.....	12
Switching the Screen to English.....	12
Attaching/Removing au IC card.....	12

Basic Operation.....	14
-----------------------------	-----------

Using touch panel.....	14
Switching between landscape and portrait view.....	15
Start screen.....	15
Icons on the status bar.....	16
Operations in common for each screen.....	16
Adjusting volume.....	16
Operations in common for applications.....	17
Application list.....	17
Referring to Help.....	18
Hubs.....	19
Using emergency earthquake information.....	19
Restricting others from using.....	20
Setting a password to lock screen.....	21
Unlocking screen.....	21
Character input.....	21
Switching keyboard.....	22
Entering text with the QWERTY keyboard.....	22
Entering text on the number keyboard.....	22
Operating cursor.....	23
Tap operation input.....	23
Entering with sliding operation.....	23

Phone.....	24
-------------------	-----------

Making calls.....	24
Entering a phone number to make a call.....	24
Making a call to the number saved to People.....	25
Calling overseas (001 international call service).....	25
Receiving a call.....	25
Checking your phone number.....	25

Setting global function.....	26
-------------------------------------	-----------

For overseas use.....	26
Acquiring a PRL (preferred roaming list).....	26



Mail	27
Setting a mail account	27
Checking received mails.....	28
Creating and sending mail	28
Configuring mail settings	29
Internet Explorer	30
Displaying a web page.....	30
Entering URL to open a web page.....	30
Setting a browser.....	30
People	31
Saving contacts.....	31
Editing contacts.....	31
Setting contacts to be display in People	32
Deleting contacts.....	32
Grouping contacts	32
Exchanging profiles	33
Having the other person read your profile.....	33
Reading the other person's profile to save	33
Messaging	34
Checking received short messages	34
Deleting short messages	34
Camera	35
Before using the camera	35
Precautions on shooting.....	35
Setting the camera.....	35
Starting the camera	36
Viewing the shooting screen.....	36
Shooting pictures.....	36
Shooting videos.....	37
Setting options at shooting.....	37
Viewing pictures/Playing videos	39

Marketplace	40
Installing an application or game.....	40
Rating applications or games	41
System settings	41
Using airplane mode.....	44
Using Wi-Fi®	44
Application settings	45
Resetting your phone	47
Backing up data	47
Resetting to the state at a time of purchase.....	48
Resetting from the menu.....	48
Resetting by key operation	48
Appendix	49
Troubleshooting	49
Rebooting your IS12T	51
Trademarks.....	51
Index	52

Getting Ready

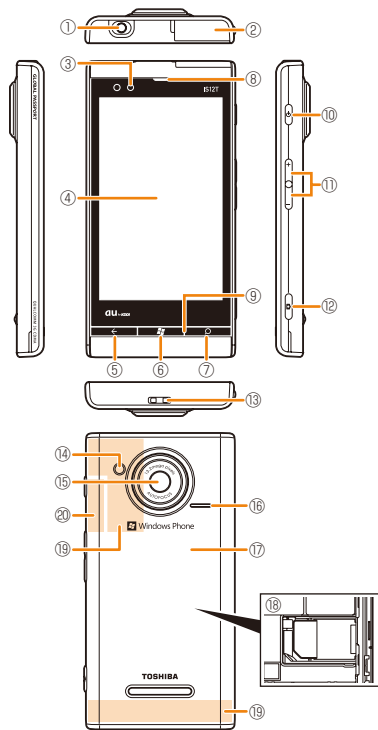
Names of parts and their functions

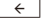

①	Earphone jack	Use to connect an earphone. An earphone acts as an antenna when using a radio. Earphone jack is waterproof. If it gets wet, drain water.
②	External connection jack	Connect to microUSB-USB conversion cable.
③	Proximity sensor/Light sensor	Proximity sensor prevents the erroneous operation of the touch panel during a call. Light sensor senses ambient brightness and automatically adjusts brightness of the display backlight.
④	Display (Touch panel)	Trace with the finger to scroll the screen or tap an item to select.
⑤	Back button 	Display the screen previously operated. Press and hold to show history of applications recently activated. When you press the button, it lights in white for a few seconds.
⑥	Start button 	Display the start screen. In sleep mode, press to cancel sleep mode. When you press the button, it lights in white for a few seconds.
	Notification LED	Light in red: While charging Light in green: While charging (fully charged) Flash in orange: Battery level is low (less than 10%)
⑦	Search button 	Search with Bing. When you press the button, it lights in white for a few seconds.
⑧	Ear speaker	Allows you to hear the caller.

⑨	Microphone	Transmit your voice. Act as a microphone when recording.
⑩	Power button Ⓞ	Press and hold to turn the power off. Press briefly to set/cancel sleep mode or turn the power on.
⑪	Volume buttons ⏮ ⏭	Adjust the voice volume or speaker volume.
⑫	Camera button Ⓞ	Activate the camera. Use as a shutter key for still picture or start/end shooting a video. In sleep mode, press and hold the camera button to activate the camera.
⑬	Strap hole	—
⑭	Camera light	Light when shooting under poor lighting condition.
⑮	Camera	Shoot still pictures or videos.
⑯	Speaker	Allows you to hear ring alert, music playback sound or the other person's voice when using speaker phone.
⑰	Battery pack cover	—
⑱	au IC card slot	Insert au IC card.
⑲	Built-in antenna	The antenna is built in.
⑳	GPS antenna	The GPS antenna is built in.

memo

- Ⓞ Do not put protective sheets, decoration stickers, etc. on the proximity sensor, light sensor, built-in antenna, or GPS antenna.
- Ⓞ If the proximity sensor or the light sensor is covered during a call, the screen turns off.
- Ⓞ Covering or touching around the built-in antenna when holding IS12T with the fingers or metal substance may reduce signal reception.

Closing external connection jack cap

- 1** Insert the hinge of the cap and then press the entire of the external connection jack cap with the ball of the finger



- 2** Slide the finger as indicated by the arrow and make sure the cap is closed and not sticking up

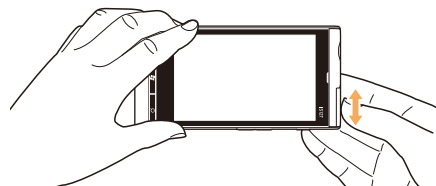

Removing/Attaching the battery pack

- Before attaching/removing the battery pack and battery pack cover, turn the power off.
- When you attach/remove the battery pack cover, hold IS12T in your hand so that you will not scratch the display etc.
- Wipe off water before removing the battery pack cover.
- Do not remove/attach the battery cover with wet hands.
- Use a dedicated battery pack for IS12T.

Removing a battery pack

- 1 Place your fingernail or a flat-blade screwdriver into the battery cover removal part ① to lift the cover until the lateral catches are removed**

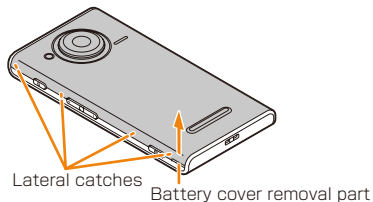

- 2 Place your fingernail or a flat-blade screwdriver into the battery cover removal part ② and lift the cover to remove it**

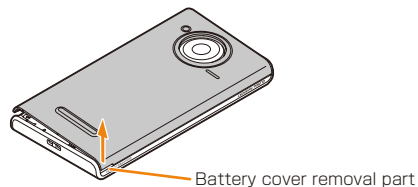

- 3 Remove the battery pack**

- Use the catch on the battery pack to lift it in the direction of the arrow.
- Lifting the battery pack from the direction other than the catch may damage the phone or the battery terminals.

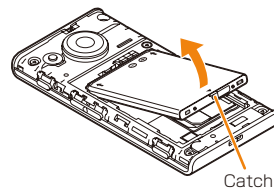

Attaching battery pack

- 1 Place your fingernail or a flat-blade screwdriver into the battery cover removal part ① to lift the cover until the lateral catches are removed

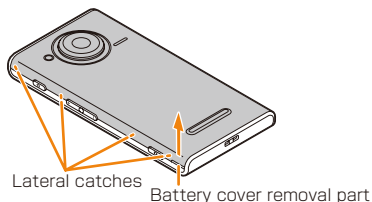

- 2 Place your fingernail or a flat-blade screwdriver into the battery cover removal part ② and lift the cover to remove it

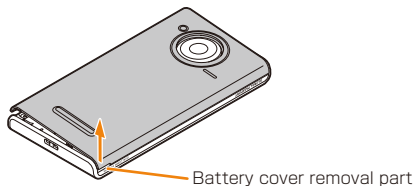

- 3 Attach the battery pack

- With \oplus \ominus on the battery pack facing up, align the contacts of the battery pack with that of IS12T and insert the battery in the direction of the arrow.
- Check the shape for the correct orientation to insert it.

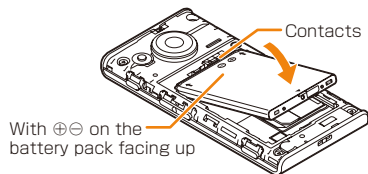

- 4 Check the orientation of the battery pack cover and fit it on your phone

Before attaching the battery pack cover, make sure that any dust is not attached to the rubber packing part on the rear side of the battery pack cover.

- 5 Press the cover by sliding fingers as indicated by the arrows to close it

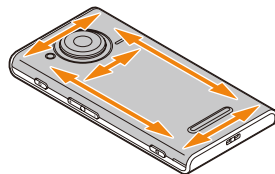

To maintain the waterproof/dustproof performance, attach the battery pack cover securely so no parts remain lifted up.

Charging

When you purchase IS12T the battery pack is not fully charged. Be sure to charge the battery pack before use. When the notification LED of IS12T flashes in orange, the remaining battery level is less than 10 percent. Charge the battery pack before use.

■ Charging times (approximate)

These times are to fully recharge the battery pack while IS12T is turned off. The charging times increase if the power is on or the temperature is low during charging.

Specified AC adapter (sold separately)	Approximately 160 minutes
Common DC adapter O1 (sold separately)	Approximately 240 minutes

■ Adapter for charging

In addition, the specified AC adapter (sold separately) or DC adapter (sold separately) is required.



memo

- The common AC adapter O1 (sold separately) uses 100 VAC used for households in Japan. Do not charge in single-phase 200 V current or using an electric transformer for traveling overseas.
- The common AC adapter O2/O3 (sold separately) supports 100 to 240 VAC. Use only the common AC adapter O2/O3 (sold separately) for charging overseas.

Charging using AC adapter (sold separately)

The following describes how to charge the battery pack using the common AC adapter O3 (sold separately). (Note that your AC adapter may be different from the illustration.)

1 Connect the AC adapter to the microUSB cable

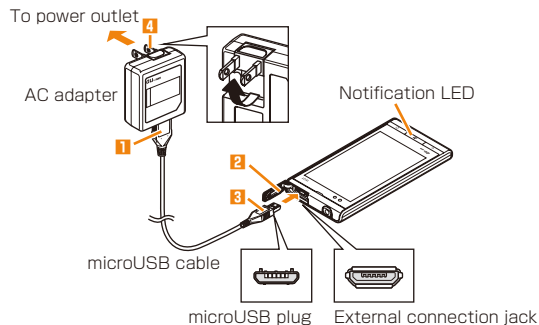

Check the shape of the connector of the AC adapter to connect.

2 Open the external connection jack cap of IS12T

3 Connect microUSB cable to IS12T

Check the shape of the microUSB plug and external connection jack to insert the plug straight.

4 Lift the AC adapter plug and insert it into the power outlet

Make sure to insert it all the way.

The notification LED of IS12T lights in red and  appears on the status bar at the top of the screen. The notification LED lights in green when charging is complete.

5 When charging ends, pull the microUSB cable straight out from IS12T

6 Close the external connection jack cap of IS12T

7 Pull the AC adapter out from the power outlet



memo

- If IS12T is charged with the battery exhausted, notification LED may not light immediately, but the charging starts.
- IS12T can also be charged by connecting it to a PC with microUSB-USB conversion cable.
- The common adapter O1 (sold separately), common AC adapter O2 (sold separately) and microUSB 18 pin (charger) converter cable O1 (sold separately) can be used to charge, but it takes longer time.
- After charging, securely close the external connection jack cap to keep out water and dust. (▶P.7"Closing external connection jack cap")
- If the battery is low, battery mark appears on the screen and any operations on IS12T cannot made.

Turning power on/off

Turning power on

1

The start screen appears.





If the unlock password is set, flick upward on the lock screen and enter the password.

When IS12T is turned on for the first time

When you turn on IS12T for the first time after your purchase or when you reboot it after its initialization, follow the onscreen instruction to set up IS12T.

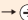

memo

- If you set Windows Live ID to "今は実行しない(Set later)" during the setup, Windows Live ID is not registered on IS12T. Register Windows Live ID by any of the following steps.
 - Access Windows Live ID website (<http://mobile.live.com/>) via IS12T and obtain an ID, then  →  →  → "email+accounts" to register
 - Access Windows Live ID website (<http://mobile.live.com/>) via a PC and obtain an ID, then  →  →  → "email+accounts" to register
 - Initialize IS12T and register during the setup

Turning power off

- 1**  (press and hold two seconds or more)
Wallpaper and a message appear at the upper half of the screen.
- 2** **Slide your finger downward on the screen**
A message "goodbye" appears and the power goes off.

Sleep mode

When  is pressed or when no operation is performed in certain period of time, the display is temporarily turned off and your phone goes into sleep mode.

Canceling sleep mode

- 1** **In sleep mode,**  / 
The lock screen appears.

memo

- You can change the idling time to go to sleep mode (screen time out).

Switching the Screen to English

- 1**  →  →  → "地域&言語"(region+language)
- 2** "表示言語" (Display language)→ Select "English (United Kingdom/United States)"
- 3** Tap "変更内容を反映するには、ここをタップして電話を再起動します。" (Tap here to accept changes and restart your phone)

After rebooting, the screen display turns into English.
English keyboard is added to the onscreen keyboards.

Attaching/Removing au IC card

Before attaching/removing the au IC card, first turn IS12T off and remove the battery pack.

memo

- When handling the au IC card, note the following to prevent malfunction or damage.
 - Do not touch the IC (metal) part of the au IC card or contacts (for the IC card) on your phone
 - Insert the IC card in the correct direction
 - Do not use excessive force to attach or remove the au IC card
- An error message appears if the au IC card is not attached correctly or if there is a problem with the au IC card.
- Do not lose the au IC card after it has been removed.

■ Removing au IC card

- 1 Press the lock ① and pull the au IC card out 2-3 mm in the direction of the arrow ②

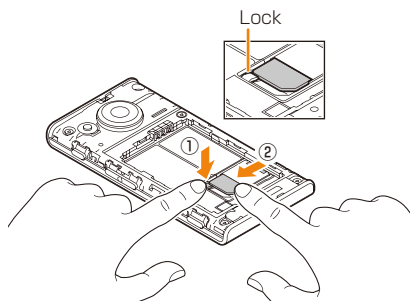

- 2 Lift your finger from the lock and press the au IC card lightly to pull out

Do not press the au IC card downward with excessive force.

■ Attaching au IC card

- 1 Insert the au IC card into the guide with the IC side facing down

Check the orientation of the IC card corner cut.

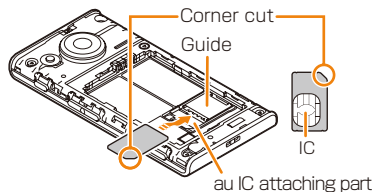

■ Authenticating PIN code after activating

When you set a PIN code, entering a PIN code is required when IS12T is activated. If you select "キャンセル (cancel)", the PIN code is not authenticated. If the global CDMA network is used, the PIN code entry screen does not appear when activating.

If the PIN code is not authenticated, making calls, connecting to the Internet using mobile network cannot be made.

To authenticate PIN code after activating, perform the following operation.

- 1  →  →  → "SIM security"

- 2 Enter PIN code → "OK"

Basic Operation

Using touch panel

The display of IS12T is a touch panel. You can operate IS12T by directly touching the screen.

Notes for using the touch panel

The touch panel is designed for being touched lightly with fingers. Do not push it forcibly with a finger or press it with sharp objects (nail, ballpoint pen, pin, etc.).

Touching the touch panel may not work in the following cases. Note that it may cause malfunction.

- Operation with gloved finger
- Operation with tip of fingernail
- Operation with a foreign object on the display
- Operation with protective sheet or seal on the display
- Operation when the display is wet or fogged
- Operation with wet or sweaty fingers
- Operation under water

Tap/Double-tap

Tap an item or icon on the screen lightly. Tapping the same position twice in a row is called double-tap.

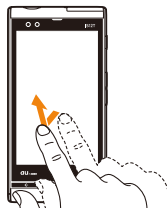

Press and hold

Press and hold your finger on an item or key. Used for displaying the context menu (▶ P.17).

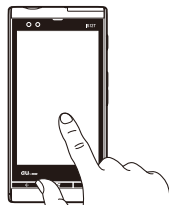

Slide

Touch the screen and drag to the desired position. Used for displaying parts you want to view if the entire screen is not visible.



Flick

Quickly slide your finger up, down, left or right on the screen. Used for changing screens or displaying parts you want to view if the entire screen is not visible.

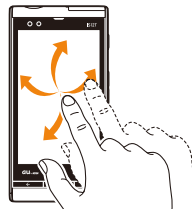

Pinch-in/Pinch-out

Touch the screen with two fingers and spread (pinch-out) or close (pinch-in) the fingers. Use to zoom in (pinch-out) or zoom out (pinch-in) a web page or image.

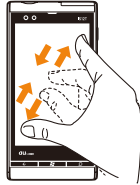

Switching between landscape and portrait view

A motion sensor detects the orientation and movement of IS12T so that the screen switches depending on if IS12T is held vertically or horizontally.

memo

- Operate IS12T in the vertical orientation. When IS12T is in horizontal orientation it cannot detect changes in orientation and movement correctly and the screen may not switch.
- Some screens may not switch.
- While performing continuous operation, do not switch screen view shifting IS12T from vertically to horizontally or vice versa.
- When it is difficult to operate in the landscape view, switch to portrait view to operate.

Start screen

The Start screen is the starting point for all operations on IS12T and is similar to the "standby screen" of conventional mobile phones. Press  at any time to display it. You can pin favorite images, shortcuts for frequently used applications, contacts, or change color, etc. to customize the Start screen.



Tap  or flick the Start screen to left to show the application list on IS12T.

Icons on the status bar

Status icons displayed at the top of the screen of IS12T tell you the current status.

Tap the top of the screen to display status icons. They become undisplayed a few seconds later.



①		Signal strength
		Out of service area
		Airplane mode
		au IC card not inserted
		au IC card locked
②	3G	Connection status "1X" appears if you are out of EVDO service area.
③		Calls are to be forwarded according to the settings
④		Roaming
⑤		Wi-Fi® signal strength
		Not connected to Wi-Fi® network (with Wi-Fi® enabled)
⑥		Bluetooth® in use
⑦		Phone set to vibrate
		Phone set to silent mode
⑧		Battery level

Operations in common for each screen

Adjusting volume

This section describes how to adjust radio and music volume and quickly switch to the silent mode.

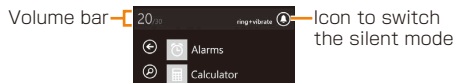

1 Press

The volume bar appears at the top of the screen.

■ To adjust volume

2 Press to adjust volume to your desired level

■ To switch to the silent mode

2

Silent mode () is activated. If "バイブレーション(Vibrate)" is set to on in the system settings, appears.

Tap again to cancel the silent mode.

memo

○ In the sleep mode, you need to cancel the sleep mode before adjusting volume.

Operations in common for applications

Operations which use in common for each application are described here.

■ Operating from the application bar



If some operations are available for each application, the application bar and icons to operate appear at the bottom of the screen. Tap ... or flick the application bar upward to display name of the icon or operation menu.

■ Operating from context menu

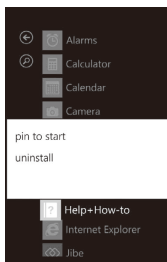

The context menu is a menu displayed by pressing and holding the screen or items which contain menu options. To hide the menu, tap a place other than menu. Displayed menu options depend on the screens or applications.

■ Displaying running applications

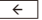
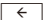
If several applications are running, press and hold  to open up to 5 running application screens (6 screens if the Start screen is activated) in reverse chronological order. Tap an application to display. To quit the running application, tap an application you want to quit and press .

1 Press and hold



The history screen of recently activated applications appears.





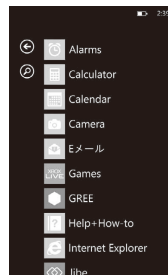









2 Select an application you want to display



Application list

On the start screen, tap  or flick to left to show the application list on IS12T.



	Alarms	Notify a specified time.
	Calculator	Perform calculations.

	Calendar	Register schedule or send a mail to the other person as promised.
	Camera	Shoot still pictures or videos. Shot data can be attached to mail or posted to Facebook.
	Games	Access Xbox LIVE to play game.
	Help+How-to	Display operation procedure for IS12T or applications.
	Internet Explorer	Access to the Internet.
	LinkCabinet	Play contents such as pictures, music, video, etc. saved in IS12T with DLNA enabled player connecting to the network.
	Maps	Show maps.
	Marketplace	It is an online store where you can try or purchase applications, music or games.
	Messaging	Receive short messages such as au phone C-mail.
	Music+Videos	Play music or videos. You can also listen to the FM radio.
	Office	Edit or view Microsoft® Office document.
	People	Manage contacts or information for communication for mail, Facebook, etc.
	Phone	Make a call. You can also check dialed/received call history.
	Pictures	View various still pictures or videos such as data shot by the camera, received data via mail, synchronized data, etc.

	Profile Exchange	Create a QR code including the profile screen information and exchange the profiles by letting the other person read with the cell phone, etc or reading a QR code including the other person's profile information.
	Settings	Make system setting up or application settings.



memo

- In IS12T, there are preinstalled applications other than the ones in the table.

Referring to Help

You can refer Help provided by Microsoft for the information on how to operate Windows® Phone 7 or how to use applications coming with the Windows® Phone 7.



memo

- The latest information of "Help+How-to" provided by Microsoft is read via Internet. Internet connection is required.
- Due to the information is provided by Microsoft, it may include descriptions that differ from the specifications of IS12T.

Hubs

6 Hubs, "People", "Pictures", "Games", "Music+Videos", "Marketplace", "Office", are ready to use on IS12T. Tap each application from the Start screen to display each Hub screen.

By starting from the contents to be used such as music, games, photos, documents, etc., hubs put contents and related applications and services together. As the Hub screen is panorama view, you can flick the hub from side to side to use each function.



Using emergency earthquake information

The emergency earthquake information service notifies all au phones around the epicenter of Japan Meteorological Agency's emergency earthquake information.

memo

- If you receive emergency earthquake information, consider surrounding conditions and calmly move to someplace safe.
- Emergency earthquake information is sent to areas where strong quakes (over 4 degrees) are expected during earthquakes anticipated above intensity 5 lower on the Japanese seven-level seismic scale in maximum seismic intensity.
- Immediately after an earthquake occurs, quakes (P waves and initial tremors) near the epicenter are detected and position, scale, and expected strength are automatically calculated and notification is sent as soon as possible within a few seconds to tens of seconds before the strong quakes (S waves and major tremors) caused by the earthquake start.
- Emergency earthquake information may not arrive before strong tremors in areas near the epicenter.
- This service is available only in Japan (it cannot be used overseas).
- There is not content or transmission charge for emergency earthquake information.
- KDDI is not liable for damages suffered by customers resulting from the service's information, lack or delay in the information caused by transmission or system breakdowns, or other events that are outside the responsibility of KDDI.
- Refer to the Japan Meteorological Agency web page for details about distribution of emergency earthquake information.
<http://www.jma.go.jp/>

- ⊙ Emergency earthquake information cannot be received during a call. Also, it may not be possible to receive emergency earthquake information while communicating such as sending/receiving a mail, receiving a short message or using the browser.
- ⊙ Emergency earthquake information cannot be received if the power is off, in areas where signals are not available even within the service area (such as in tunnels or when underground), or if the condition of the signal is bad.
- ⊙ If this happens, the notification cannot be received again.
- ⊙ This delivery system is different from emergency earthquake information provided through TV, radio, or other communication procedures, which means that the time the emergency earthquake information arrives may vary.
- ⊙ Information from someplace other than your current location may be received.
- ⊙ It is not possible to set not to receive emergency earthquake information or change the warning sound.

Restricting others from using

You can set a password for screen lock to restrict others from using. If a password is set, entering a password is required when unlocking screen.



- ⊙ You can lock IS12T by remote access from a PC in case IS12T is misplaced. For details, refer to "Help+How-to".

Lock screen



If no operation is performed in certain period of time, IS12T goes into sleep mode. When the sleep mode is canceled, the lock screen appears.

Bottom of the lock screen, numbers of unread short messages, incoming calls, unchecked mails are displayed. On the lock screen normal operations cannot be made, except for the following operations.

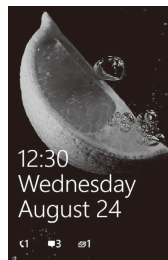
- Making an emergency call
Flick upward to show the keypad, tap "emergency call" and enter an emergency number.
- Receiving a call
- Receiving mail
- Listening to the music or FM radio
- Shooting pictures and videos
Press and hold to activate camera and shoot a picture or video. If a password is set to the lock screen, from the screen displayed after activating camera, tap to enter the password and unlock.





Setting a password to lock screen

- 1  →  →  → "lock+wallpaper"
- 2 "Screen times out after" → Select time you want to set
- 3 Set "Password" to On
A password entry screen appears.
- 4 Enter a password in "New password" → Re-enter the password in "Confirm password" → "done"

memo



- ◎ It is recommended to note down the password. If you forget the password and cannot operate IS12T, you need to reset your phone.
- ◎ If you enter a wrong password five times, you cannot enter a password for 1 minute.
- ◎ Compose a password of 4 digits or more.
- ◎ Tap "Require a password after" to set time interval before a password is requested.

Unlocking screen

- 1 In the sleep mode, press  / 
- 2 Flick upward
- 3 If a password is set, enter the password
The previously displayed screen appears.

Character input

The following keyboards are ready to use by default. Both keyboards have two types of input, tap operation and slide operation.

<p>QWERTY keyboard</p> 	<p>Characters are arranged on the keyboard the same as on a conventional computer.</p>
<p>Number keyboard</p> 	<p>Characters are arranged the same as the keyboard on a conventional mobile phone. The display switches in four input modes (Kana/alphabet/number & symbol/emoticon, symbol, special character).</p>

memo

- ◎ IS12T does not support emoji characters.
- ◎ If the display language is switched to English, in addition to these keyboards, QWERTY keyboard for English input can also be used.

Switching keyboard

Press and hold "ENU" to select number keyboard or QWERTY keyboard.



Entering text with the QWERTY keyboard

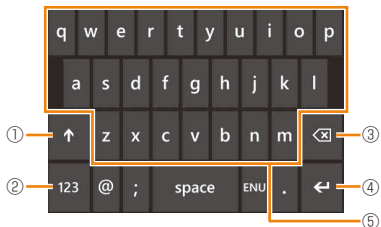

①	Uppercase/lowercase switch key	Switch between uppercase and lowercase. Double-tap to fix uppercase input mode.
②	Character/number switch key abcd: alphabet &123: number, symbol	Switch between character input and number input.
③	Delete key: X	Tap to delete a character.

④	Set/Enter key: ←	Insert line feed at the cursor position. Set entered character when converting.
⑤	Input panel	Display is changed by the character/number switch key.

Entering text on the number keyboard

There are 4 input modes (kana/alphabet/number, symbol/emoticon, symbol, special character) for number keyboard.



①	Cursor keys ← →	Move the cursor or select word prediction candidate. When entering characters, ← is changed to ↶. Tap to display in the reverse order.
②	Input mode switch key あい: kana abc: alphabet 1&: number & symbol ☺: emoticon, symbol, special character	Switch input mode.
③	Delete key: X	Tap to delete a character.
④	Set/Enter key: ←	Insert line feed at the cursor position. Set entered character when converting.

⑤	Input panel	Display is changed by the input mode switch key.
---	-------------	--

Operating cursor

On the QWERTY keyboard, there are no keys for moving the cursor. To move the cursor, operate as follows. The same operations are available on the number keyboard.

1 Press and hold the desired place in an entry field

The color and form of the cursor (I) change at the place you press and hold.

2 Slide the finger where you want to move the cursor to

The display of cursor changes and cursor moves to the position you release the finger.

Tap operation input

On the number keyboard, tap a key which is allocated a character you want to enter continuously until the target character appears. When entering characters and **↶** is displayed, tap to display characters in the reverse order. When entering Japanese by the QWERTY keyboard, enter by Romaji input.

Entering with sliding operation

Press and hold a key to which a character you want to enter is allocated to display input candidate. Slide to a character you want to enter.



(Number keyboard)



(QWERTY keyboard)

Phone

Making calls

memo

- You cannot make a call if airplane mode is set to On (✈). See "Using airplane mode" (▶P.44).

Dial services available from au phones

- Call with fixed-line phones all over Japan
- Call with cell phones, PHS, and car phones all over Japan
- 001(001 international call service: Subscription is unnecessary)
- 171(Disaster Emergency Message Dial)
- 177(Weather forecast: The area code is necessary)
- 117(Time signal)
- 104(Directory assistance)
- 115(Sending telegram)
- 110(Emergency call to Police)★
- 119(Emergency call to Fire and Ambulance)★
- 118(Emergency call to Regional Coast Guard Headquarters)★
- 157(Customer Service Center)
- Maritime telephone

※ The numbers with ★ are emergency call numbers.

If "emergency call" is displayed on the screen, you can make an emergency call by tapping "emergency call". However, when you are in Japan, you cannot make an emergency call by tapping "emergency call" if the screen for entering PIN code is displayed or your phone is locked by PIN code.

※ The following NTT services are unavailable. Collect call, message service, dial Q2, 116(NTT business information)



Dialed and incoming call histories are displayed.

2 **From the histories, tap  of the person you want to call**

3 **"end call"**

memo

- Tap a phone number or name from the histories to show the profile screen for People. You can make a call from the screen. Sending short messages is not supported and you cannot send a message even if you tap "SMS" to create a message.
- To delete all dialed and incoming call histories, from the history screen, tap ... to display the menu and then select "delete all". To delete a history, press and hold a history you want to delete and select "delete item" in the displayed menu.
- To save a phone number in the dialed and incoming histories to "People" as a contact, tap the number and tap .

Entering a phone number to make a call





2  → **Enter a phone number → "call"**

To call a landline phone, first input the city code, even if you are in that city.

If you enter a wrong number, tap  to delete the entered number.

3 **"end call"**

memo

- To save an entered phone number to "People" as a contact, tap "save".
- To hear voice from the speaker, tap .
- If you just hear without making conversation, tap .

Making a call to the number saved to People

You can call up "People" from the history screen to make a call. "People" (▶P.31) is an application which manages information of the parties to communicate such as phone numbers, mail addresses, Facebook accounts information, etc.



2  → Select a person you want to call → Select a phone number to dial

3 "end call"



◎ You can set a contact to the start screen or select a person from "People" to make a call.

Calling overseas (001 international call service)

You can make international calls from your IS12T without any special procedure.

Example: To call "212-123-XXXX" in the USA from your IS12T



2  → Enter an access code, country code, city code, and the phone number

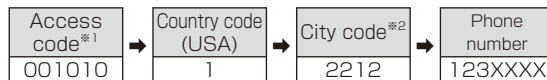

*1 Press and hold "0" to enter "+" and the access code (001010) is automatically added.

*2 If the city code begins with "0", omit "0".

3 "call"

Receiving a call

■ When the phone is locked

1 Slide upward and "answer"

■ When the phone is unlocked

1 "answer"



◎ Voice mails or messages are indicated with icons in the start screen.

Checking your phone number



2 ... → "call settings"

Your phone number is displayed in "My phone number".

Setting global function

IS12T supports "GLOBALPASSPORT GSM", "GLOBALPASSPORT CDMA" and you can use the phone in the overseas supported area without special procedures. Some functions cannot be used. Note that using packet communication overseas may require high charges. For details, refer to the au website.



The overseas network condition is available on the au homepage.
Make sure to check the condition before leaving Japan.
<http://www.au.kddi.com/service/kokusai/tokomae/>

memo



- Before leaving Japan, make sure to check "Phone number for inquiries when overseas" described in the au homepage and note it down. For loss or theft of the cell phone or au ID card, immediately contact the number for inquiries to take the necessary steps for suspending the use.
- If your au IC card is lost or stolen, it may be used improperly by inserting to another cell phone (including a global GSM cell phone) by a third party. To prevent those risks, setting PIN code is recommended.(▶P.3)

For overseas use



■ To use overseas CDMA network

- 1  →  →  → "cellular"
- 2 Select "CDMA" for "Mode selection"

memo

- PIN code entry screen to be displayed when you turn on the phone with PIN code enabled ("SIM security" is set to On) is not displayed.  → Tap  →  → "SIM security" to authenticate PIN code.

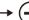
■ To use overseas GSM network

- 1  →  →  → "cellular"
- 2 Select "GSM" for "Mode selection"
When network is searched, search result appears. Go to Step 4.
- 3 Select "tap to select" for "Network selection"
Search result appears.
- 4 Select a network you want to access

Acquiring a PRL (preferred roaming list)

The PRL (Preferred roaming list) is information about overseas service providers with whom KDDI (au) has a contract for international roaming. You need to acquire PRL to use IS12T in a CDMA network area.

- 1  →  →  → "wireless settings"
→ "PRL settings" → "Download"

Download PRL data by following the on-screen instructions.
Acquired PRL version information appears in "Version".

memo

- Acquire the most recent PRL before traveling abroad.
- Note that you may not be able to communicate in some areas overseas if you use an old PRL.

Mail

You can set a mail account usually used on a PC, etc. to IS12T so that you can send and receive mails just like you can on a PC.

memo

- ◎ To send and receive mails, packet communication charge which depends on data amount is required. Overseas usage may require high charges. For details, refer to the au catalog or au website. If you use Wi-Fi® connection, packet communication charges are not applied.
- ◎ When a file is attached or depending on the radio wave conditions in the area of use, it may take a time to send or receive mails.
- ◎ Decoration Mail and Emoji Mail are not supported.

Setting a mail account

Before sending or receiving mail, you need to set a mail account.

You can set the following mail accounts on IS12T. Obtain mail accounts on a PC beforehand.

- Windows Live account
- Google (Gmail) account
- POP/IMAP mail account provided by Internet service providers (ISP)

memo

- ◎ If you set/sign in Windows Live account after purchasing IS12T, you need not set a new account. If you have several Windows Live IDs, additional accounts can be set.
- ◎ In addition to the accounts mentioned above, Microsoft Exchange account can be set. For setting Microsoft Exchange account, contact Exchange server manager.

1  →  →  → "email+accounts"
→ "add an account"

2 Select mail account type

Item	Account type
"Windows Live"	Windows Live account
"Outlook"	Microsoft Exchange account
"Google"	Google (Gmail) account
"other account"	POP/IMAP mail account provided by ISPs

3 Enter mail address in "Email address"

4 Enter Windows Live password or mail password in "Password"

5 "sign in"

Mails in the set account is synchronized with (downloaded to) IS12T.

memo







- If you fail to sign in, follow the on-screen instructions to enter mail address and password again.
- "Attention required" appears when you failed to sign in even if you enter mail address and password for POP/IMAP mail account. Tap an account name and enter correct mail address and password.

Checking received mails

When mails are received, the number of mails appears on the tile for mail account on the start screen.

1 → (set account name such as Google Mail)

Content of mail is displayed.

- If you need not reply or forward, press  to return INBOX.
- To delete a mail, tap .
- To download attached file, tap . If several files are attached, tap "Show all attachments" and then tap .
- Read next or previous mail of the inbox, tap  or .
- To switch read/unread or move to another folder, tap  to operate.
- To reply or forward, go to the following step.

2 → "reply"/"reply all"/"forward"

3 Edit as required →

memo

- If you want to delete a file attached to the original mail when forwarding, tap "remove" and tap "yes".
- When URL, phone number, mail address are included in a mail, tap to start each application.

Creating and sending mail

1 → (set account name such as Google Mail) →

A new message screen is displayed.

2 Create a mail



①	Enter a contact or a mail address as destination. <ul style="list-style-type: none"> • Tap  and tap a contact you want to send a mail. • Enter mail address. For addresses to which is sent, when you enter the address on the halfway, candidate address appears. Tap the address you want to send. • To delete the added contacts or addresses, tap the target and tap "remove".
②	Enter a subject.
③	Enter your message.
④	Tap to attach an image data.
⑤	Tap to stop creating a mail or save message as a draft to send later.
⑥	Tap to add CC/BCC or set priority to message.

3

Created mail is sent.

Configuring mail settings

You can automatically insert your signature or always set yourself to BCC when creating mail.

1  →  (set account name such as Google Mail) → ... → "settings"

2 Set required items

sync settings	Set mail synchronization setting.
Conversations	If set to On, related received mail threads are displayed sequentially under the first mail. Mails in the same folder are covered.

In conversations, show replies and email from all your synced folders	Appears only when "Conversations" is set to On. If marked, mails you replied are also included to sequentially displayed mails.
Signature	Set to automatically insert signature when creating a mail. Set to On and enter signature in the inferior text box. "Sent from my Windows Phone" is set by default as signature.
Always bcc myself	Always set yourself to BCC when creating mail.

3

Internet Explorer

You can use a browser to view web pages just as you can on a PC. IS12T can use Internet Explorer® Mobile as a browser.

Displaying a web page



- Some web pages may not be displayed or not be displayed normally.
- For the first activation of Internet Explorer Mobile, a screen asking whether to send browsing history to Microsoft appears.

Entering URL to open a web page



Internet Explorer Mobile starts and an one homepage opens.

2 Enter a URL in the address bar

When you enter the URL on the halfway, candidate URL appears.

3 Select the displayed URL or enter the URL to the end,

The specified web page opens.

To stop reading web page, tap in the address bar.

Setting a browser

1 → → → Flick to display "applications" → "Internet Explorer"

2 Set required items

Allow access to my location	Set to On if you allow to read your location information.
Allow cookies on my phone	Allow/Not allow to save/read Cookie.
Get suggestions from Bing as I type	Show/Hide candidate URL or keyword when entering in the address bar.
Allow Internet Explorer to collect my browsing history	Allow/Not allow to send browsing history.
Website preference	Set display style of web page to "Mobile version" (suitable for IS12T) or "Desktop version" (suitable for a PC).
Open links from other apps in	Set whether to read linked destination into current displayed tab screen or read into a new tab screen when opening links from other applications.
delete history	Delete cash files, history, Cookie, and passwords for Internet Explorer Mobile.



- Note that prohibiting reading and saving of Cookies limits the use of some web services.
- You can use the filtering function to block web pages that are not appropriate for children, such as dating sites and porn sites.

People

"People" is an application which manages information of the persons to communicate such as phone numbers, mail addresses, Facebook accounts information, etc. If several accounts (Facebook, Google, etc.) are set, all contacts are shown in "People".



◎ Contacts from Facebook cannot be created or deleted. Contacts information of Facebook friends cannot be edited either. But you can add information (phone numbers, another image for profile, etc.) to contacts and store as another account (Windows Live, for example).

Saving contacts



2 Flick to display "all" → ⊕

3 "new contact" → Select an account to save, if necessary → Each item → Enter information → ⊗

If several accounts are set, tap "new contact" to display a screen for selecting a saving location. The following items can be set.

name	Set First name, Last name, Company, etc.
phone	Set phone numbers for mobile, home, work, company, etc.
email	Set mail addresses for personal, work, other, etc.
ringtone	Set ringtones when receiving a call and mail.
other	Set information for address, birthday, website, etc.

4 "add photo" → Select an image → Adjust size and layout → ✓

You can also tap to shoot a photo and save it.

5



memo

◎ Tap to check the ringtone.

Editing contacts



2 Flick to display "all" → Select a contact to edit → ✎

If you want to edit a linked contact, tap an account to edit.

3 Select an item to edit → Edit content → ⊗

Tap an image to change the image.

Setting contacts to be display in People

In addition to the contacts created on IS12T, Facebook friends, etc. are automatically displayed as contacts in "People". You can filter contacts out to display in "People".

1 → → → Flick to display "applications" → "people"

The setting screen appears.

2 "filter my contact list"

Accounts of contacts displayed in "People" appear.

3 Select accounts of contacts you want to display

Leave if you do not display.

4

Deleting contacts

Although Facebook contacts on IS12T cannot be deleted, contacts for other services can be deleted. Contacts deleted from IS12T are also deleted from the online services in which they are saved.

1 →

2 Flick to display "all" → Select a contact to delete → ... → "delete"

If you select a linked contact, tap a profile to delete. A confirmation message appears.

32 3 "delete"

memo

- You can delete one account at a time. Facebook account information cannot be deleted.

Grouping contacts

You can bind contacts together into groups such as family, circles, etc. If you create groups, you can set groups to tiles on the start screen or send a mail to the members of a group at the same time.

1 →

2 Flick to display "all" → → "new group"

Editing group screen appears.

3 Enter a group name → "add a contact"

A screen for selecting group members appears.

4 Select members

Tap  to search members.

Selected members appear in "members".

5

memo

- To delete members from a group, select a group →  → Select members you want to delete → Tap "remove from group" → "remove from group".
- To delete a group, select a group you want to delete → Tap ... → "delete" → "delete".

Exchanging profiles

To exchange profiles, create a QR code including your profile information and have the other person read with the mobile phone, etc or read a QR code including the other person's profile information.

Having the other person read your profile



Profile screen appears.

2 Enter information as required

QR code is made according to the entered information.

3 ... → Select a telecommunications carrier of the phone of the other person who reads

4 Have read the QR code with the other person's phone

Tap the QR code to magnify.

5 To save the created QR code,

The entered information is saved.



© On some types of mobile phones, part of the profile may not be correctly displayed.

Reading the other person's profile to save



- © QR codes which include information other than profile information (URL, advertising, etc.) cannot be read.
- © If fingerprints, grease, etc. are attached to the camera lens, barcodes may become blurred and hard to be read. And if dirt, such as hair or dust is attached, barcodes may not be read correctly. Clean with a soft cloth, etc before reading.

1 Display a QR code on the other person's phone

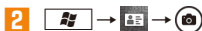

A screen for reading a QR code appears. A square frame (guide) appears on the center of the screen.

3 Fit the QR code in the guide

When the phone succeeds in reading, a screen for editing contact including the profile information.

If the contact editing screen does not appear, tap "ok" to re-read QR code.

If several accounts are set in People, a screen for selecting an account appears. Tap the account where you want to save the contact.



4 Edit as required →

The contact is saved in "People".

Messaging



IS12T can receive text messages called Short Message Service (SMS).

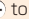

memo

- Short Message Service is a service that enables the sending and receiving of short messages between mobile phones. The service is provided as "C-mail" by au phone.
- IS12T can receive C-mail from au phones and short messages from mobile phones of other telecommunications carriers.
- IS12T does not support emoji characters.
- IS12T cannot send a short message. If you create and send a message, "Can't send message" appears.
You can tap  →  →  to create a message. But you cannot send the created message.
You can select "share...", "Messaging", etc. from the context menu of other applications to open a new message screen and you can create a new message. But the created message cannot be sent.
- MMS (Multimedia Messaging Service) is a service that enables the sending and receiving of messages attached with image files, music files, etc. MMS is not supported by au mobile network. Thus, messages attached with files cannot be received. Due to functions which use MMS cannot be used, "messaging" → "Group text" in the Application settings is disabled.

Checking received short messages

Short message receiving status is indicated on  of the start screen.

	There is no unread message.
	You have an unread message. The number of the messages is shown.
	You have 4 or more unread messages. The number of messages is shown.

Tap  to display short message threads list. Select a thread from the list to display short message content. Received short message is displayed in the  call-out.

memo

- When a phone number or a mail address is included in a short message, tap to start each application.

Deleting short messages



- To delete a specified short message
- 2** Select a thread including a short message you want to delete → Press and hold the short message → "delete" → "delete"
- To delete a thread at a time
- 2** Select a short message thread you want to delete →  → "delete thread" → "delete"

Camera

Before using the camera

Precautions on shooting

- Shooting video while charging or shooting video for a long time heats IS12T up. In such case, an alarm sounds and the shooting video stops, and then you return to the start screen. Note that the camera function cannot be used.
- If file size of the video exceeds 4 GB, it cannot be transferred to a PC with Zune PC software. For transferring the video to a PC, make sure not to exceed the following shooting time for each mode.

4:3 QVGA (320×240): Approx. 8 hours

4:3 VGA (640×480): Approx. 2.8 hours

16:9 HD (1280×720): Approx. 1 hour

Copyrights and rights of portrait

Avoid reproducing, altering, or editing taken or recorded pictures or sounds using IS12T without the copyright holder's authorization, because, except for personal use etc., they are prohibited by the Copyright law. Avoid using or altering pictures of others without their consent, because they may infringe on portrait rights. Note that taking photos or recordings at some demonstrations, performances or exhibitions may be prohibited even when only for personal use.





Please be considerate of the privacy of individuals around you when taking and sending pictures using camera-enabled mobile phones.

Setting the camera

Make the camera settings as needed.

- 1  →  →  → **Flick to display "applications" → "pictures+camera"**

The following items can be set.

Tap screen to take pictures	Set to On to shoot by tapping the screen.
Press and hold camera button to wake up the phone	Set to On to wake your phone from sleep mode and start the camera by pressing and holding  .
Prevent accidental camera launch when phone is locked	Set to On not to activate the camera accidentally by pressing  when IS12T is in a bag or pocket.
Include location info in pictures you take	Set whether to include location information to the pictures you take.
Keep location info on uploaded pictures	Set whether to include location information on uploading pictures.
Automatically upload to SkyDrive	Set whether to upload the pictures you take to SkyDrive® automatically.
Quick Share Account	Set account of priority for uploading.
reset camera	Reset the settings of shooting option (▶P.37) to the state at the time of purchase.



memo



- © When "Automatically upload to SkyDrive" is set to On, you can use SkyDrive for backup destination just in case.

Starting the camera

Start the camera by one of the following operations.

- Press .
- Tap  →  → .

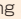







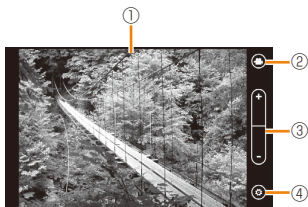

- When you start the camera for the first time, if a message asking whether you want to allow the camera to use your location appears, set whether to add location information to pictures.
Tap "allow" to add location information. This setting can be changed later. For details on how to change it, see "Setting the camera" (▶P.35).
- Even in sleep mode, you can start the camera by pressing and holding . This setting can be changed later. For details on how to change it, see "Setting the camera" (▶P.35).
- When you start the camera in sleep mode or during screen lock with password set, unlock by tapping  on the shooting screen and then enter the password.





Viewing the shooting screen

When you start the camera, the shooting screen is displayed.







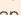

①	View finder	Check composition on shooting. Half-press  to focus on. A focus frame appears in the center. When the focus is fixed, sound is emitted. Press  to shoot. When "Tap screen to take pictures" is On, you can focus on other than the center. Tap a point you want to focus to display the focus frame. When the focus is fixed, sound is emitted and photo is shot automatically. For "Tap screen to take pictures", see "Setting the camera" (▶P.35).
②	 	Switch picture () / video () shooting.
③		Set zoom magnification for shooting.
④		Set shooting options. ▶P.37 "Setting options at shooting"

Shooting pictures

- 1 Confirm  is displayed on the shooting screen**
- 2 To change the shooting options, **
For option settings, see "Setting options at shooting" (▶P.37).
- 3 Set magnification with **
- 4 Shoot a pictures by **
Half-press  to focus, and then press until the shutter sound is emitted.
The picture is automatically saved to camera roll.

memo

- ① When "Tap screen to take pictures" is On, tap a point you want to focus. The camera automatically focuses on the point and shoot. For details, see "Setting the camera" (▶P.35).
- ② Tap  to view the picture you took. Tap  to display the following menu.

share...	Sharable account is displayed. However, you cannot use "Messaging".
share on SkyDrive/share on Facebook	Upload to SkyDrive or Facebook. You can put tags to link with yourself or the other person in "People" or add description. If you put tag with the other person displayed in "People", individual personal album is created in "pictures".
use as wallpaper	Uses the picture as lock screen wallpaper. Set display range as needed and tap  .
delete	Deletes the picture.
add to favorites	Adds the picture to "favorites" of "Pictures".
auto-fix	The picture is are automatically corrected. Tap  to save the corrected pictures. Tap  to return to the original. Tap  to end.

Shooting videos

1 Shooting screen →

Switched to  and video shooting screen is displayed.

2 To change the shooting options,

For option settings, see "Setting options at shooting" (▶P.37).



3 Set magnification with

4 to start shooting

5 to stop shooting

The video is automatically saved to camera roll.

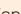
memo

- ① Tap  to view the video you shot. Tap  to display the following menu.

share...	Sharable account is displayed.
share on SkyDrive/share on Facebook	Upload to SkyDrive or Facebook. When uploading, you can add description.
delete	Deletes the video.

Setting options at shooting

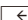
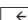
You can set shooting options for pictures/videos. After each item is set, use  to return to the setting item list. To use the settings for the next activation of camera, select "Save settings". To change the settings temporarily and shoot, use  to return to the shooting screen.

Option item	Description
Save settings	Save settings. You can use the same settings when you start the camera next time.
Restore default settings	Reset to the state at a time of purchase.

Option item	Description
Scene	<p>Set according to shooting scene.</p> <p>Picture You can select from "Auto" (default value)/"Standard"/"Night"/"Landscape"/"People"/"Backlight"/"Sports"/"Characters"/"High sensitivity". When "Auto" is selected, "Standard"/"Night"/"Landscape"/"Auto focus:Macro" is applied according to the shooting scene.</p> <p>Video You can select from "Standard" (default value)/"Landscape"/"Backlight"/"Sports".</p>
Resolution	<p>Set shooting size.</p> <p>Picture Select from the following settings.</p> <ul style="list-style-type: none"> • 4:3 VGA (640×480) • 16:9 Full HD (1920×1080) • 4:3 3M (2048×1536) • 4:3 5M (2592×1944) • 4:3 8M (3264×2448) • 4:3 13M (4128×3096) (default value) <p>Video Select from the following settings.</p> <ul style="list-style-type: none"> • 4:3 QVGA (320×240) • 4:3 VGA (640×480) • 16:9 HD (1280×720) (default value)

Option item	Description
Auto focus	<p>Select shooting scene using auto-focus function from the following settings.</p> <ul style="list-style-type: none"> • "Standard" (default value): Use auto-focus function for usual shooting. • "Macro": Use auto-focus function for macro shooting.
Orientation (only for pictures)	Select from "On" (default value)/"Off" for switching portrait/landscape view of picture automatically at saving.
Anti-shake	Select from "On" (default value)/"Off" for hand shake correction.
Quality (only for pictures)	Select image quality from "Low"/"Standard" (default value)/"High".
Effect	Select color effect on image from "Off" (default value)/"Sepia"/"Monochrome".
Flicker	When you shoot near fluorescent light, set current area frequency to reduce flicker of the screen. Select from "Auto" (default value)/"50Hz"/"60Hz". "Auto" determines 50Hz or 60Hz automatically.
White balance	Set white balance according to the brightness of the place where you shoot. Select from "Auto" (default value)/"Sunlight"/"Cloudy"/"Fluorescent"/"Incandescent".

Option item	Description
Flash (//)	Set operations for light and flash.
Light (/)	<p>Picture Select from the following settings.</p> <ul style="list-style-type: none"> • : Light/Flash Auto (default value) • : Light/Flash OFF • : Light/Flash ON <p>Video Select from the following settings.</p> <ul style="list-style-type: none"> • : Light ON • : Light OFF (default value)

Viewing pictures/Playing videos

1 → "Pictures"

"pictures" appears.

2 **Category you want to view picture/play video** → **Select thumbnail of picture or video you want to view/play**

Enlarged image is displayed. Flick left or right to switch previous/next image/video.

For videos, tap on the enlarged screen to start playing. Tap ... to display menu. You can share or delete videos.

For pictures, you can operate the following on the enlarged screen. However, depending on the selected image, some operation may not be performed.

Operation	Method
Zoom in/out	<ul style="list-style-type: none"> • Operate by pinching in/ pinching out. • Double-tapping enlarges the screen. Double-tapping again to return to the original.

Operation	Method
Turn picture to portrait view/ landscape view	Hold IS12T vertically or horizontally to switch portrait/ landscape view.
share... / share on SkyDrive / use as wallpaper / delete / add to favorites / remove from favorites / auto-fix, etc.	Tap ... and operate from the menu.



memo

- You are recommended to back up your important pictures and videos by tapping "share on SkyDrive" and uploading them to SkyDrive for backup on network.
- You can set the images you shot to upload to SkyDrive automatically by → "Pictures" → Tapping "camera roll" to display camera roll screen → "turn on auto upload".

Marketplace

To add applications or games to IS12T, use the Internet store called Marketplace.

In Marketplace, you can search/try applications or games and then download/install to IS12T.

memo

- Be sure to check the security of file, and then install it at your own risk. By some files, your phone may be infected with a virus and the data may be damaged, or may send your location information/usage history/personal information outside.
- KDDI is not liable for malfunctions, if any, caused by the application you installed. Note that the repair may be charged even during the warranty period.
- KDDI is not liable for any disadvantage brought to you or any third party due to an application you installed.
- Some files access the Internet and perform communications automatically. Note that high packet communication charge may be applied.
- Files more than 20 MB cannot be downloaded via packet communication. Use Wi-Fi® connection.
- To purchase an application or game, setting credit card information linked with Windows Live ID is required.

Installing an application or game



"marketplace" is displayed.

2 Tap "apps" or "games"

Flick to search an application/game.

Alternatively, tap  and enter a keyword to search.

3 Tap a name of application/game

A detailed information screen appears.

4 Confirm rating or review and select any of "try"/"install"/"buy"

- To try, tap "try" and start installation.
- To install free application/game, tap "install" and start installation.
- To buy and install paid application/game, tap "buy". A purchase confirmation screen appears. If you do not register credit card information to your Windows Live account, register it. Tap "buy" to start installation. When the installation is complete, it is added to the application list or "games".

■ When "SET UP ACCOUNT" screen is displayed after tapping "install" etc.



5 Set "Date of birth" →

6 "accept"

A gamer tag is assigned.

7 "done"

memo

- You can delete installed applications and games. For games, delete from  → .
- If you try to register in minor age, an error will be displayed and you cannot register the account. The registered information on the account cannot be changed.
- If you try to register Xbox LIVE account in minor age, accessing Marketplace is disabled.

Rating applications or games



"marketplace" is displayed.

2 Select an application or game you want to rate

A detailed information screen appears.

3 Flick to display "reviews"→"rate and review"

4 Tap rating stars and then enter review comment in the "write a review" field

5 "submit"

System settings

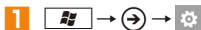

2 Select necessary items in the system settings

Setting items and the content are as follows.

Note that the table below shows settings at a time of purchase with "region+language" set to "日本語 (Japanese)". If "region+language" is set to "English", some displayed items may differ.

Item	Content	Default value	Description
ringtones+ sounds	Ringer	On	Set notification sound for receiving messages or mails. Also set alarm sound or key touch tone.
	Vibrate	On	
	Ringtone	Flow	
	New text or IM	alert 10	
	New voicemail	alert 1	
	New email	none	
	Reminders	<input checked="" type="checkbox"/>	
	Key press	<input checked="" type="checkbox"/>	
	Lock and unlock	<input checked="" type="checkbox"/>	
All other notifications	<input checked="" type="checkbox"/>		
theme	Background	dark	Select accent color or background theme color. Selected colors are used for tiles of the start screen, application list, Web link, Messaging, etc.
	Accent color	original	

Item	Content	Default value	Description
airplane mode	Status	Off	Although call/communication function is Off in airplane mode, you can use the other applications that require no mobile connection (▶P.44).
Wi-Fi	Wi-Fi networking	On	Set Wi-Fi® connection to on/off. Also set whether to be notified when a new Wi-Fi® network is detected (▶P.44).
	Notify me when new networks are found	<input checked="" type="checkbox"/>	
	advanced	—	
Bluetooth	Status	Off	Set Bluetooth® connection to on/off.
email+ accounts	add an account	—	Create, set (edit) mail account and SNS account. You can check the details of the settings by tapping an account which already set.
lock+ wallpaper	change wallpaper	—	Set IS12T to be locked automatically when you do not operate a certain period of time to prevent from tapping or button operations.
	Show artist when playing music	Off	
	Screen times out after	1 minute	
	Password	Off	
location	Location services	On	Set for using applications which use location information such as maps etc.

Item	Content	Default value	Description
cellular	Data connection	On	Set to switch to the network of your destination country/region when you use the phone overseas.
	Data roaming options	don't roam	
	Mode selection	Global mode	
battery saver	Always turn on Battery Saver when battery is low	<input type="checkbox"/>	Set the timing of moving to battery saver mode. Also check current battery level.
	Turn on Battery Saver now, until next charge	<input type="checkbox"/>	
date+ time	24-hour clock	On	Set time display and time setting method. When "Set automatically" is set to off, you can set time zone/date/time individually.
	Set automatically	On	
brightness	Automatically adjust	On	Set backlight brightness. When "Automatically adjust" is set to Off, you can set light level.
	Level	medium	
keyboard	typing settings	—	Set a language for keyboard. You can also set character input settings. Setting menu for character input differs depending on the keyboard you set.
	Choose keyboard languages	<ul style="list-style-type: none"> • Japanese 12Key • Japanese QWERTY 	

Item	Content	Default value	Description
region+ language	Display language	日本語 (Japanese)	Set a language for menu, keyboard, etc.
	Region format	日本語 (Japanese)	
	Short date (sample)	2011/01/02	
	Long date (sample)	2011年1月2日	
	First day of week	日曜日 (Sunday)	
	System locale	日本語 (Japanese)	
	Browser & search language	日本語 (Japanese)	
speech	—	—	Operate IS12T by voice sound. When the language settings to "日本語 (Japanese)", this function is disabled.
find my phone	Connect to these features faster (may use more battery)	<input type="checkbox"/>	Settings for searching your phone using "FIND MYPHONE" on http://windowsphone.live.com when you lost your phone.
	Save my location every few hours for better mapping	<input type="checkbox"/>	
phone update	Notify me when new updates are found	<input checked="" type="checkbox"/>	Set notification method of software update program.
	Use my cellular data connection to check for updates	<input checked="" type="checkbox"/>	

Item	Content	Default value	Description
about	more info	—	Display IS12T information. Also reset IS12T to the state at a time of purchase (▶P.47).
	reset your phone	—	
feedback	Send feedback	On	Settings for sending your usage status data that is useful for improvement of function of Windows® Phone.
	Use my cellular data connection to send feedback	<input type="checkbox"/>	
wireless settings	femtocell	On	In femtocell, set whether to search femtocell (small cell phone base station unit installed at home etc.). In filtering, restrict access to hazardous site. In PRL settings, set for using your phone overseas. Do not use "Advanced settings" usually. Changing the settings might disable data communication.
	filtering	Off	
	PRL settings	—	
	Advanced settings	—	
SIM security	—	—	Authenticate when IS12T is turned on and PIN lock is not authenticated.

Item	Content	Default value	Description
Sound Quality Settings	Clear Voice	On	Set whether to make listening of the other person's voice easier for calling.

Using airplane mode

In airplane mode, calling function, Wi-Fi® and Bluetooth® are off at the same time. However you can use the other applications that require no mobile connection (listening music, watching video, etc.). Also you can set/cancel Wi-Fi®, Bluetooth® individually.

1  →  →  → "airplane mode"

2 Set to On



- ⦿ When "SIM security" is set to On, switching the airplane mode to Off from On makes PIN code security valid. Authenticate PIN code.

Using Wi-Fi®

By default, your phone's Wi-Fi® connectivity is turned on and always ready to connect to a Wi-Fi® network. Your phone will notify you periodically if there are available Wi-Fi® networks in your area, and you can tap the notification to connect to the network.

Your phone will automatically connect to networks to which you have previously connected when you come within range of those networks.

Available channels

Wi-Fi® function of IS12T uses frequency band between 1 and 11 channel.

Connecting Wi-Fi® network

1  →  →  → "Wi-Fi"

2 Make sure that "Wi-Fi networking" is set to On

Available Wi-Fi® networks are detected by this setting. If a network is found, your phone will list it and note whether it's an open or secure network.

3 Select the network you want to connect to



- ⦿ If connection to network is disconnected, re-connect it manually.
- ⦿ To connect to an access point after rebooting, make the network settings again.
- ⦿ If there is any available Wi-Fi® network, you are notified of that at regular intervals. Tap the notification to connect the network or stop the notification.
- ⦿ To connect a network with security settings, enter the password (Security key) and then tap "done". A password (Security key) is set by the access point. For details, contact a network administrator.
- ⦿ To disconnect network connection, press and hold the network you want to disconnect, and then select "delete".
- ⦿ When multiple WEP keys can be registered to an access point, enter the first registered WEP key. And set the WEP key to use on the access point.
- ⦿ Tapping "advanced" deletes the connection log.

Application settings

Make each setting of application. Some applications can be set in the applications.

1  →  →  → **Flick to display "applications"**

2 **Select necessary items in the application settings**

Setting items and the content are as follows.

Item	Content	Default value	Description
background tasks	advanced	—	Make settings for background operating applications.
games	Connect with Xbox LIVE	On	Make settings related to games.
	Sync game requests	On	
	Show game alerts	On	

Item	Content	Default value	Description
Internet Explorer	Allow access to my location	On	Make the display settings and security settings for Internet Explorer Mobile (▶P.30).
	Allow cookies on my phone	<input checked="" type="checkbox"/>	
	Get suggestions from Bing as I type	<input checked="" type="checkbox"/>	
	Allow Internet Explorer to collect my browsing history	<input type="checkbox"/>	
	Website preference	Mobile version	
	Open links from other apps in delete history	The current tab —	
maps	Use my location	Off	Make settings related to maps.
	delete history	—	
messaging	Group text	On	"Group text" is invalid because MMS is not supported. If Facebook is registered, "Facebook Chat" is displayed.
music+ videos	Zune Account Settings	—	Make settings for connection using Zune.

Item	Content	Default value	Description
Office	User name	User	Make settings related to Office.
	Open SharePoint links in the Office hub	<input checked="" type="checkbox"/>	
	UAG server	—	
	reset Office	—	
people	import SIM contacts	—	Make display settings, etc. for contacts. Create, set (edit) mail account and SNS account. You can check the details of the settings by tapping an account which already set. "import SIM contacts" is not supported.
	filter my contact list	—	
	Only show my contact list	<input type="checkbox"/>	
	Use my location	Off	
	Save check-in history with my Windows Live ID to improve search results	<input type="checkbox"/>	
	add an account	—	
phone	My phone number	—	Settings in the phone are displayed. Also settings of support function for international calls or phone usage overseas, or long tone settings can be made. Some items are not displayed depending on phone state.
	Voicemail number	1416	
	International assist	On	
	SIM security	Off	
	Long tones	On	

Item	Content	Default value	Description
pictures+ camera	Tap screen to take pictures	On	Make settings related to the camera and shot images (▶P.35).
	Press and hold camera button to wake up the phone	On	
	Prevent accidental camera launch when phone is locked	Off	
	Include location info in pictures you take	Off	
	Keep location info on uploaded pictures	On	
	Automatically upload to SkyDrive	Off	
	Quick Share Account	—	
reset camera	—		
radio	Region	Japan	Set the area where you are listening to the radio.



Item	Content	Default value	Description
search	Use my location	Off	Settings for using search function.
	Send location info for Microsoft Tags	<input type="checkbox"/>	
	Allow search button from lock screen	<input checked="" type="checkbox"/>	
	Get suggestions from Bing as I type	<input checked="" type="checkbox"/>	
	Allow Microsoft to store and use images from vision searches	<input checked="" type="checkbox"/>	
	delete history	—	

Resetting your phone

Note that this operation erases all downloaded applications, information set in "People" etc., and shot and downloaded image data, etc. Each setting is also reset to the state at a time of purchase.

Backing up data

Back up your data before resetting to the state at a time of purchase as needed.

Data type	Back up method
Shot images (images in camera roll)	Use Zune PC software to save to a PC. Also upload images to SkyDrive by displaying images you are going to back up → ... → "share on SkyDrive" → Tap  /  .
WordMobile/ Excel Mobile/ PowerPointMobile document	Open document you are going to back up, ... → Tap "save as..." to upload.

Note that the following data is not necessary for backing up because they are saved on network.

After resetting to the state at the time of purchase, set your account again. The information will be displayed on IS12T.

Data type	Saving location on network
Contacts	Accounts with contacts such as Windows Live, Google (Gmail), etc.
Calendar	Windows Live and Google (Gmail) accounts
Data related to mail	Mail accounts such as Windows Live, Google (Gmail), etc.
OneNote Mobile document	SkyDrive

memo

- ◎ You cannot back up the following data.
 - Applications/games installed from Marketplace
After resetting to the state at a time of purchase, install them again.
 - Favorites of Internet Explorer Mobile
For files such as music, video, podcast saved to IS12T using ZunePC software, reset IS12T to the state at a time of purchase, and then save them again.

Resetting to the state at a time of purchase

There are two methods; operation from the menu and key operations of IS12T.

Resetting from the menu

If IS12T is turned on, reset from the menu.

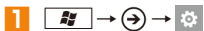

2 "about" → "reset your phone"

A confirmation message appears.

3 "yes" → "yes"

After a while, IS12T reboots and then starts setup.



Resetting by key operation

If you forget password to unlock the screen and cannot operate IS12T, or if IS12T does not start, reset by key operation.

1 Power off if IS12T is turned on.

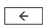
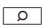
2 With pressing  and , press and hold 



Release your fingers when LED indicators of  and  flash in white.

3 Press and hold ,  and  at the same time

Release your fingers when a starting precaution screen appears.

After a while, IS12T reboots and then starts setup.

memo

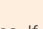
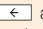
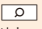
- ◎ If you do not perform the reset, press  until flashing  and  stops.
- ◎ Flashing  and  in white continues for 2 minutes. If you do not operate anything, reset will be canceled and the phone will start as usual.
- ◎ If the remaining battery level is low, the power might be forcibly turned off on the way of resetting. Charge the battery and then perform reset.
- ◎ Do not remove the battery pack on the way of resetting. The phone might not reboot.

Appendix

Troubleshooting

Symptom	What you should check
IS12T does not turn on.	<ul style="list-style-type: none"> Is the battery pack installed correctly? Is the battery pack dead?
Cannot charge the battery pack. (LED indicator does not light or flash.)	<ul style="list-style-type: none"> Is the battery pack installed correctly? Is the power plug of the AC adapter plugged correctly into a power outlet or vehicle cigar lighter? When using the AC adapter (sold separately), is the supplied microUSB-USB conversion cable connected correctly to IS12T and the AC adapter (sold separately)? If you are using the supplied microUSB-USB conversion cable, is the computer turned on?
IS12T becomes warm during operation or charging.	<ul style="list-style-type: none"> Your IS12T, battery pack or adapter might heat up, for example, during operation or charging, or when watching video for a long time while charging the battery. However, you can continue to use your phone since there is no problem in terms of safety.
Screen turns on and off during charging.	<ul style="list-style-type: none"> Screen might turn on and off if you start charging the completely empty battery. However you can continue to charge the battery since there is no problem.
Screen is not displayed even if sleep mode is deactivated.	<ul style="list-style-type: none"> When the battery becomes completely empty, goodbye screen appears and the power turns off even if in sleep mode. Charge the battery and then perform operation.

Symptom	What you should check
Battery charge life is short.	<ul style="list-style-type: none"> Are you leaving the phone for long periods in an area that is outside the service area? Outside the service area, the phone searches for a connection, which consumes more electric power than normal. Battery pack charge life depends on conditions of use and the level of battery pack deterioration. The battery pack is a consumable item. Repeated charging shortens the battery pack charge life. Buy a new specified battery pack if the usage time becomes much shorter, even after being fully charged, than when the battery was first bought.
Power cuts off or IS12T restarts.	<ul style="list-style-type: none"> Dirty battery pack terminals can cause poor contact, resulting in power turning off. Use a dry cotton swab to wipe off any dirt from the battery pack terminals.
The correct operation is not performed when I tap.	<ul style="list-style-type: none"> Are you wearing gloves? Are you tapping with the tips of your fingernails or with an object? Is a protective sheet affixed to the display? Some types of protective sheets may interfere with proper operation. The display of IS12T uses an electrostatic touch panel. Touch the display with your finger to perform operations.
Nothing happens when I touch the display	<ul style="list-style-type: none"> Turn the power off and then back on again.
Screen response is slow when I tap the screen or press a button.	<ul style="list-style-type: none"> This can happen when you are saving a large volume of data to your IS12T or transferring a large volume of data.
Data is not displayed normally or normal Touch screen operations are not possible.	<ul style="list-style-type: none"> Restart your IS12T.

Symptom	What you should check
The phone turns on, but operation is not possible.	<ul style="list-style-type: none"> Is the PIN code input screen displayed? Input the PIN code.
I cannot release the screen lock.	<ul style="list-style-type: none"> Is the password input screen displayed? Enter the password to release the screen lock.
Nothing happens when I press a button.	<ul style="list-style-type: none"> Is IS12T in sleep mode? Press @/[] to cancel sleep mode.
IS12T operation is slow/application operation is unstable/some applications do not start up.	<ul style="list-style-type: none"> Operation becomes unstable when remaining IS12T memory capacity runs low. If the low memory message appears, delete applications you do not need in order to free up memory space.
The phone will not recognize the au IC card.	<ul style="list-style-type: none"> Was the au IC card facing correctly when you inserted it?
The clock reading is not correct.	<ul style="list-style-type: none"> The clock reading sometimes becomes incorrect if you leave IS12T on for a long time. After making sure that "date+time" of "Set automatically" is turned on, turn IS12T off and on in a location where signal reception is good.
I cannot place calls.	<ul style="list-style-type: none"> Is the au IC card installed in IS12T correctly? Are you entering the number with its area code? Is IS12T in airplane mode?
The ringtone does not sound.	<ul style="list-style-type: none"> Is the ringer volume set to "0"? Is forward all selected as the call forwarding service?

Symptom	What you should check
Phone stops suddenly during video shooting/ I cannot activate the camera	<ul style="list-style-type: none"> When IS12T becomes high temperature state, activating the camera fails and start screen appears. Camera function is controlled to be disabled when IS12T is in high temperature state. Avoid high temperature place, wait for a while until IS12T temperature becomes low, and then perform operation.
I cannot use the phone. (Out of service area does not disappear from the display even though I move to a different location, cannot make or receive calls even though signal conditions are not bad.)	<ul style="list-style-type: none"> Turn IS12T off and then back on again or remove and reload the au IC card. Depending on signal properties, placing or receiving calls may not be available even though signals are strong and five antenna marks are shown (). Change to another location and try again. In crowded places, heavy telephone/mail traffic can make it difficult to get a connection or use mail. In such locations, the message "Please wait for a while" will be displayed and you will get a busy signal. Change to another location or wait for a while and then tray again.
The display is dark.	<ul style="list-style-type: none"> Check the backlight "brightness" setting.
During a call, the other person's voice is hard to hear or too loud.	<ul style="list-style-type: none"> Did you change the call volume?
The still pictures and movies I shoot with the camera are out of focus.	<ul style="list-style-type: none"> Is the camera lens clouded or dirty?
Cannot connect to a Bluetooth® device/ cannot find it with device search	<ul style="list-style-type: none"> Check if the setting of Bluetooth® device you are trying to connect to be discoverable. If you are going to re-register an already-registered Bluetooth® device, cancel the pair settings for both IS12T and the Bluetooth® device and then register the device.

Symptom	What you should check
I cannot make calls from IS12T when it is connected to a Bluetooth® device such as car navigation system, hands-free device, etc.	<ul style="list-style-type: none"> • Calls may not connect to a number if you are making multiple calls to another person who does not answer or is outside the service area. If this happens, turn IS12T off and then back on again.

- If you cannot find the solution to your problem in the above table, visit the au website below and check the "Troubleshooting" section under au Customer Support.
<http://www.kddi.com/customer/service/au/trouble/kosho/index.html>

Rebooting your IS12T

Try to reboot your IS12T if data is not displayed normally, or if your tapping or key operations do not work properly.

1 Press and hold Ⓞ (Approx. 10 seconds)

When you press and hold Ⓞ, the screen display turns off. After confirming the display is turned off, release your finger from Ⓞ. IS12T reboots after a while.

Trademarks

The company names and product names mentioned in this manual are either trademarks or registered trademarks of their respective companies.

- Microsoft, Bing, Excel, Hotmail, Internet Explorer, OneNote, Outlook, PowerPoint, SkyDrive, Windows Live, Windows Phone, Xbox LIVE, Zune, and Windows are either registered trademarks or trademarks of Microsoft Corporation in the United States and/or other countries.
- The Bluetooth® word mark and logos are owned by the Bluetooth SIG, Inc. and any use of such marks by FUJITSU LIMITED is under license.
- Wi-Fi® is a registered trademark of Wi-Fi Alliance.
- "QR Code" is a registered trademark of DENSO WAVE INCORPORATED.
- REVORECT LIB QR Encoder is installed on IS12T. REVORECT is a registered trademark of FUJITSU COMPUTER TECHNOLOGIES LIMITED.
- Facebook® is a registered trademark of Facebook, Inc.
- "Google" is a trademark of Google, Inc.
- Other company names and product names mentioned in this manual are trademarks or registered trademarks of their respective companies.

Index

A

AC adapter	10
Airplane mode.....	44
Application list.....	17
Application settings.....	45
au IC card.....	12

B

Backing up data.....	47
Basic operation.....	14
Basic package.....	1
Battery pack	8
Battery pack cover	8

C

Calling overseas.....	25
Camera.....	35
Pictures	36
Videos.....	37
Character input.....	21
Charging.....	10
Charging times.....	10
C-mail.....	34
Contacts.....	31

E

Emergency earthquake information	19
---	----

G

Global function.....	26
----------------------	----

H

Help.....	18
Hubs	19

I

Icons.....	16
Internet Explorer	30

K

Keyboard	21
----------------	----

L

Landscape view.....	15
Lock screen.....	20

M

Mail	27
Mail account.....	27
Making calls	24
Marketplace	40
Messaging	34

P

People.....	31
Peripheral equipment.....	1
Phone.....	24
PIN code	2,3
Portrait view	15
Profiles Exchanging.....	33
PUK code.....	3

R

Rebooting IS12T	51
Receiving a call.....	25
Resetting IS12T.....	47

S

Safety Precautions.....	ii
Security code and password	2
Short message.....	34
SkyDrive®	35
Sleep mode.....	12
SMS.....	34
Start screen.....	15
System settings.....	41

T

Troubleshooting.....	49
Turning power on/off	11

U

Unlocking screen	21
------------------------	----

V

Volume.....	16
-------------	----

W

Wi-Fi®	44
--------------	----

Y

Your phone number	25
-------------------------	----

Z

Zune PC software.....	35
-----------------------	----

For inquiries, call: Customer Service Center

For general information and charges (toll free)

From fixed-line phones: 0077-7-111 | From au cell phones:
157 area code not required

PRESSING ZERO WILL CONNECT YOU TO AN OPERATOR
AFTER CALLING 157 ON YOUR au CELL PHONE

For loss, theft or damage and operation information
(toll free)

From fixed-line phones: 0077-7-113 | From au cell phones:
113 area code not required

In case above numbers are not available,
(toll free)

0120-977-033 (except Okinawa)

0120-977-699 (Okinawa)



Cell phone and PHS operators collect and recycle unused telephones, batteries and battery chargers at stores bearing the  logo regardless of brand and manufacturer to protect the environment and reuse valuable resources.

July 2011 Edition

Sales: KDDI CORPORATION •

OKINAWA CELLULAR TELEPHONE COMPANY

Manufactured by: FUJITSU TOSHIBA MOBILE COMMUNICATIONS LIMITED